

ROHS
Compatible

Laser Point

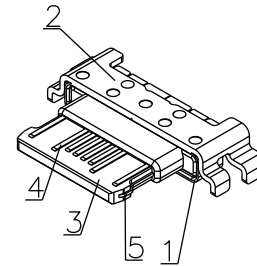
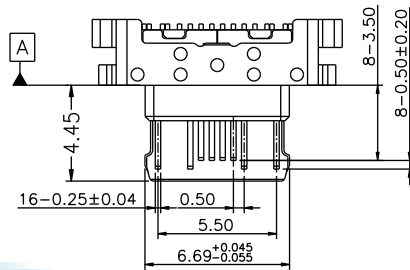
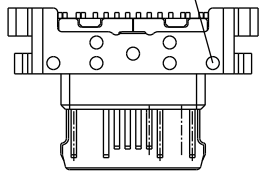

SPECIFICATION:

1. ELECTRICAL:

- 1.1 CURRENT RATING:3A/5A;
- 1.2 CONTACT RESISTANCE:40mΩ Max;
- 1.3 DIELECTRIC WITHSTANDING VOLTAGE:150V AC;
- 1.4 INSULATION RESISTANCE:150V DC/100 MΩ MIN;

2. MECHANICAL:

- 2.1 MATING FORCE:5~20N;
- 2.2 UNMATING FORCE:8~20N;
- 2.3 DURABILITY:10000 CYCLES;6~20N AFTER DURABILITY TEST;

3. MATERIAL:

- 3.1 HOUSING&MOLDING:LCP UL94V-0;
- 3.2 TERMINAL:C2680/C7025 T=0.15mm;
- 3.3 SHELL:SUS201/304 T=0.30mm;
- 3.4 MID PLATE:SUS301 T=0.15mm;

4. PLATING SPECIFICATION:

- 4.1 TERMINAL:CONTACT POINT GOLD PLATED 1u "MIN
- 4.2 SHELL:PLATED Ni 60u" MIN

5. ELECTROPLATED PRODUCTS NEED TO UNDERGO TIN ADHESION TESTING: THE TIN ADHESION AREA SHOULD REACH OVER 95%.

6. SMT REFLOW SOLDERING (PEAK VALUE 260 °C ± 5 ° C) SHALL BE FREE OF BLISTERING, GLUE MELTING AND POOR COLOR CHANGE (DEFORMATION WITHIN TOLERANCE)

7. OPERATING TEMPERATURE: -40°C~+85°C

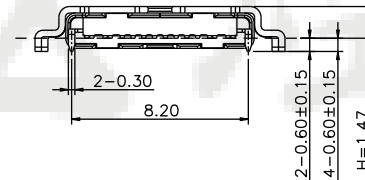
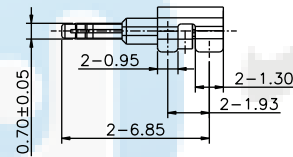
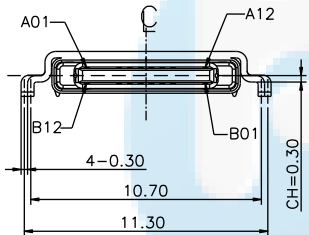

U5 407- 16P x 0.6C x 7.5L
 ↓ ↓ ↓ ↓ ↓ ↓ ↓
 名称 流水号 PIN位 N;母座 C;沉板 W;舌头外露 L;长度

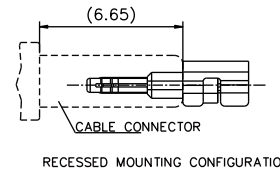
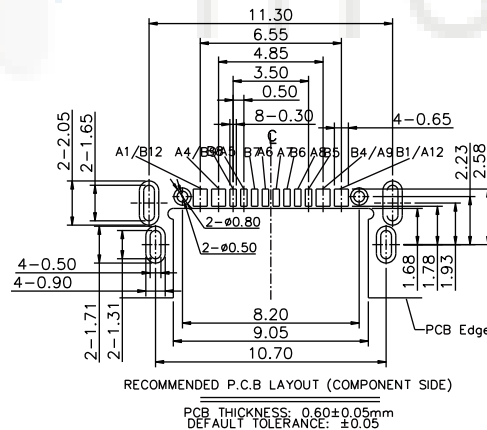
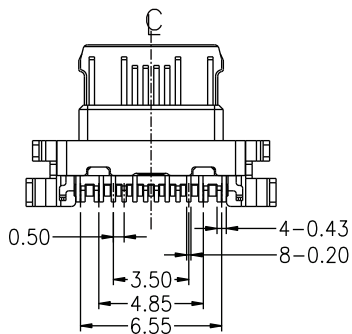

A1	GND	B12	GND
A4	VBUS	B9	VBUS
A5	CC1	B8	SBU2
A6	D+	B7	D-
A7	D-	B6	D+
A8	SBU1	B5	CC2
A9	VBUS	B4	VBUS
A12	GND	B1	GND
PIN	SIGNAL NAME	PIN	SIGNAL NAME

DESIGN	Li Jinwei	SC ALL		<p>TOLERANCE .XX ±0.30 .X°±2° .XX ±0.20 .X°±1° .XXX ±0.10 .XX°±0.5°</p>	DRAWG NO. U5407-16PN0.6CW7.5L
DRAWING	Wu Qifa	UNIT	mm		TITLE:
CHECK	Zheng Jinxian	SIZE	A4: 210 * 297		16P 沉板0.6mm 四脚插板SMT 舌头外露4.45mm 7.5L
APPROVAL	Liu Xiaohong	DATE	2020-06-10		



东莞市宏煜盛实业有限公司
 Dongguan hongyusheng Industry Co., Ltd
 TEL: 0769-81230179 <https://www.hystypec.com>