

ROHS
Compatible

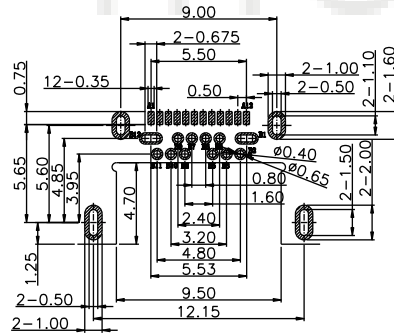

RECOMMENDED P.C.B LAYOUT(Both sides are sample)
Tolerance:±0.05,Thickness=0.60mm

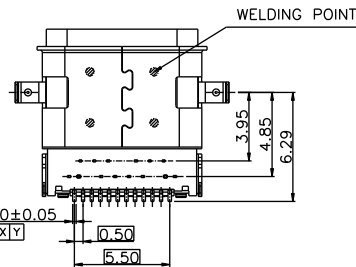
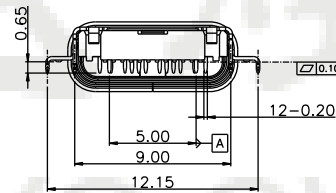
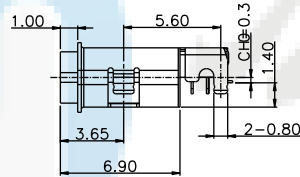
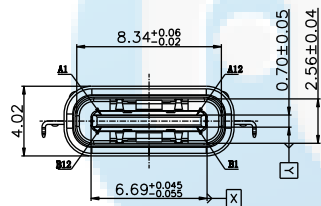
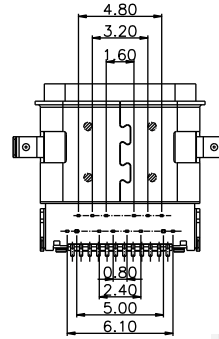
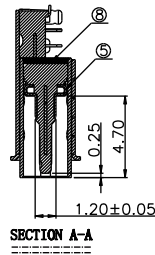
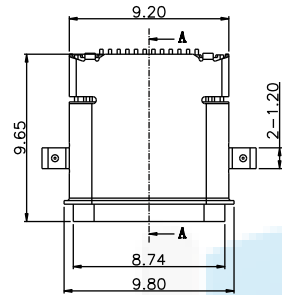
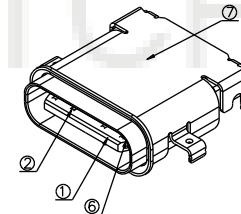
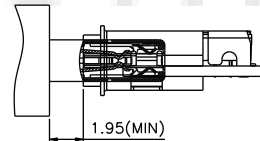

NOTES:

- MATERIAL: SEE "TABLE 1";
 - FINISH: SEE "TABLE 1";
 - ELECTRICAL :
 - CONTACT CURRENT RATING :
 - (V_{BUS} PIN 1.5A/PIN),
 - (GND PIN 1.25A/PIN MAX),0.25A/PIN(OTHER PIN).
 - INSULATION RESISTANCE :
 - 100 MEGAOHMS MIN. AT 250VDC.
 - DIELECTRIC WITHSTANDING VOLTAGE :
 - 100VAC MIN.
 - LOW LEVEL CONTACT RESISTANCE :
 - INITIAL 40mΩ MAX.
 - AFTER 50mΩ MAX.
 - MECHANICAL CHARACTERISTICS :
 - MATING FORCE: 5~20N;
 - UNMATING FORCE: 8~20N(INITIAL),6~20N(AFTER 10000 CYCLES);
 - DURABILITY : 10,000 MATING CYCLES.
 - OPERATING TEMPERATURE :-40°C TO +80°C
- 名称 流水号 PIN位 N;母座 C;沉板 L;长度 F;防水

Pin	Signal Name	Mating Sequence	Pin	Signal Name	Mating Sequence
A1	GND	First	B12	GND	First
A2	SSTxp1	Second	B11	SSRXp1	Second
A3	SSTxn1	Second	B10	SSRXn1	Second
A4	V _{bus}	First	B9	V _{bus}	First
A5	CC1	Second	B8	SBU2	Second
A6	Dp1	Second	B7	Dp2	Second
A7	Dn1	Second	B6	Dp2	Second
A8	SBU1	Second	B5	CC2	Second
A9	V _{bus}	First	B4	V _{bus}	First
A10	SSRXn2	Second	B3	SSTXn2	Second
A11	SSRXp2	Second	B2	SSTXp2	Second
A12	GND	First	B1	GND	First
SHELL	GND		SHELL	GND	

TABLE 1:

NO.	PART NAME	QTY	MATERIAL	DESCRIPTION	REMARK
⑧	GLUE WATER	1	Epoxy	BLACK;	
⑦	Shell-2	1	Stainless steel	PEARL NI PLATING;	T=0.20mm
⑥	Shell-1	1	Stainless steel	PEARL NI PLATING;	T=0.20mm
⑤	GND PLATE	1	Stainless steel	NI PLATING;	T=0.10mm
④	MID PLATE	1	Stainless steel		T=0.15mm
③	Terminal-B	12		CONTACT AREA:AU15u"	T=0.12mm
②	Terminal-A	12	C7025	CONTACT AREA:AU15u"	T=0.12mm
①	Housing	1	HIGH TEMP NYLON	Black	
NO.	PART NAME	QTY	MATERIAL	DESCRIPTION	REMARK

DESIGN	Li Jinwei	SCALL		 TOLERANCE X.X ±0.30 X.°±2° .XX ±0.20 .X°±1° .XXX ±0.10 .XX°±0.5°	DRAWG NO.	U5035-24PN1.4C9.65LF
DRAWING	Wu Qifa	UNIT	mm		TITLE:	防水24P 板上四脚插板 沉板1.4mm DIP+SMT 9.65L IPX7
CHECK	Zheng Jinxian	SIZE	A4: 210 * 297			
APPROVAL	Liu Xiaohong	DATE	2020-06-10			

东莞市宏煜盛实业有限公司
 Dongguan hongyusheng Industry Co., Ltd
 TEL: 0769-81230179 <https://www.hystypec.com>

ROHS
Compatible

密封方式

机壳面板

SEAL RUBBER

PCB

前后组装方式

Space(Panel with Seal Rubber)0.30Min
(The amount of compression is recommended as 40%~50% of seal rubber O.D.)

Space(Panel with Seal Rubber)0.30Min
(The amount of compression is recommende as 40%~50% of seal rubber O.D.)

1.45(REF)

seal rubber

PCB

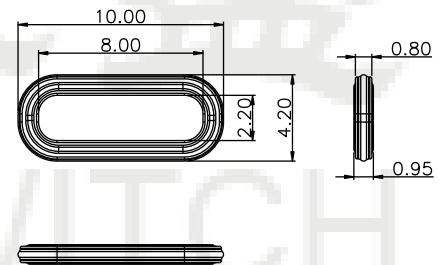

DESIGN	Li Jinwei	SCALL		\varnothing TOLERANCE .XX ± 0.30 X. $^{\circ} \pm 2^{\circ}$.XX ± 0.20 .X. $^{\circ} \pm 1^{\circ}$.XXX ± 0.10 .XX $^{\circ} \pm 0.5^{\circ}$	DRAWG NO.	U5035-24PN1.4C9.65LF
DRAWING	Wu Qifa	UNIT	mm		TITLE:	防水24P 板上四脚插板 沉板1.4mm DIP+SMT 9.65L IPX7
CHECK	Zheng Jinxian	SIZE	A4: 210 * 297			
APPROVAL	Liu Xiaohong	DATE	2020-06-10			



东莞市宏煜盛实业有限公司
Dongguan hongyusheng Industry Co., Ltd
TEL: 0769-81230179 <https://www.hystypec.com>