

**ROHS**  
Compatible

NOTES:

1. CONTACT CURRENT RATING: 1A.
2. CONTACT RESISTANCE: 50 mΩ MAX.;
3. INSULATION RESISTANCE: 100MΩ MIN.;
4. DIELECTRIC WITHSTANDING: 500V AC MIN.;
5. DURABILITY: 5,000 CYCLES MIN.;
6. CONNECTOR MATING FORCES: 29.4N (3.00KgF) MAX.;
7. CONNECTOR UNMATING FORCES: 2.94N(0.30KgF) MIN.;
8. PRODUCT MEET THE REQUEST OF THE RoHs, SEE TABLE A:

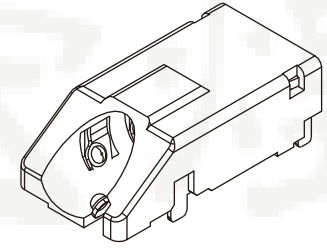
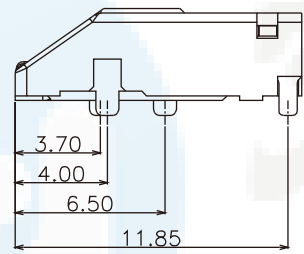
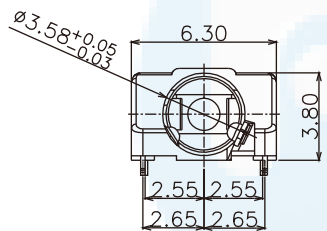
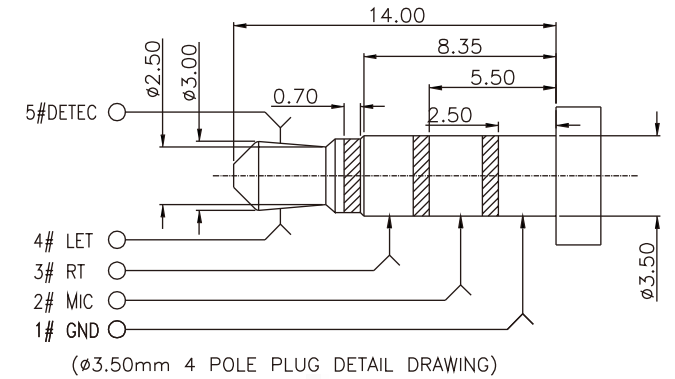

3D VIFW

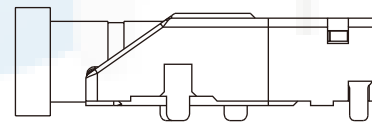

PLUG MATE DRAWING

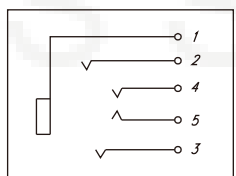

SCHEMATIC

|   |        |
|---|--------|
| 5 | DETECT |
| 4 | LET    |
| 3 | RT     |
| 2 | MIC    |
| 1 | GND    |

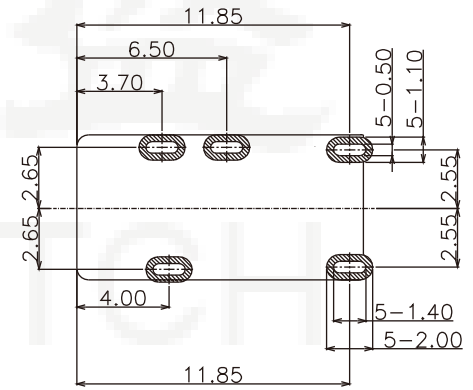

RECOMMEND PCB LAYOUT  
TOLERANCE :±0.05

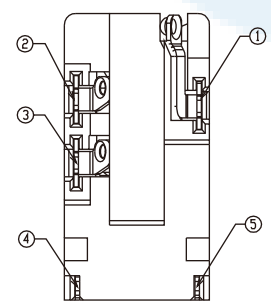

|      |            |      |   |        |
|------|------------|------|---|--------|
| ⑤    | HOUSING    | 1    | HIGHT TEMPERATURE PLASTIC; COLOR BLACK  |        |
| ④    | CONTACT 4# | 1    | STAINLESS STEEL; NICKEL UNDER PLATING OVERALL,GOLD FLASH PLATING ON SOLDER AREA ;GOLD FLASH PLATING ON CONTACT AREA | T=0.2  |
| ③    | CONTACT 3# | 1    |   | T=0.2  |
| ②    | CONTACT 2# | 1    | PHORPHOS BRONZE; NICKEL UNDER PLATING OVERALL,GOLD FLASH PLATING ON SOLDER AREA ;GOLD FLASH PLATING ON CONTACT AREA | T=0.2  |
| ①    | CONTACT 1# | 1    |   | T=0.2  |
| ITEM | PART NAME  | Q'TY | MATERTAL  | REMARK |

|          |               |       |               |
|----------|---------------|-------|---------------|
| DESIGN   | Li Jinwei     | SCALL |               |
| DRAWING  | Wu Qifa       | UNIT  | mm            |
| CHECK    | Zheng Jinxian | SIZE  | A4: 210 * 297 |
| APPROVAL | Liu Xiaohong  | DATE  | 2020-06-10    |

|            |           |
|------------|-----------|
| TOLERANCE  |           |
| X.X ±0.30  | X.°±2°    |
| .XX ±0.20  | .X°±1°    |
| .XXX ±0.10 | .XX°±0.5° |

|           |                    |
|-----------|--------------------|
| DRAWG NO. | PJ-404             |
| TITLE:    | ø3.5mm耳机插座 板上型斜口全插 |

**东莞市宏煜盛实业有限公司**  
Dongguan hongyusheng Industry Co., Ltd  
TEL: 0769-81230179 <https://www.hystypec.com>