

**ROHS**  
Compatible

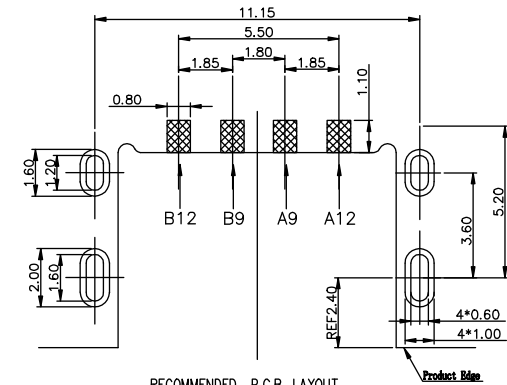
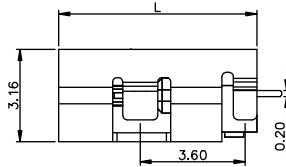
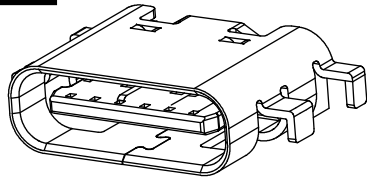

RECOMMENDED P.C.B. LAYOUT  
TOLFRANCF UNSPFCIFID F0.05mm

**NOTE:**

**1.MATERIAL SPECIFICATION:**

- 1.HOUSING:HIGH TEMPERATURE RESISTANT PLASTIC,UL94 V-0.
- 2.CONTACTS:COPPER ALLOY
- 3.MID PLATE: STAINLESS STEEL
- 4.FRONT SHELL: STAINLESS STEEL

**2.PLATING SPECIFICATION:**

**2-1.CONTACTS:**

Ni 50u" MIN. UNDER PLATED OVER ALL.

Au PLATED ON THE FUNCTIONAL AREA OF CONTACT.

(GOLD PLATING THICKNESS FOLLOW THE P/N)

PLATING SPECIFICATIONS OF THE SOLDER AREA FOLLOW THE P/N

**2-2.FRONT SHELL:**

SEE TABLE1.

**2-3.SHIELD PLATE&EMI PLATE:**

CLEAR ONLY

**3.MECHANICAL PERFORMANCE,**

3-1.INSERTION FORCE: 0.5~2.0kgf.

3-2.REMOVAL FORCE: 0.8kgf~2.0kgf.

3-3.DURABILITY: 5000 CYCLES.

**4.ELECTRICAL PERFORMANCE,**

4-1. CURRENT RATING: 3.0A

VOLTAGE RATING: 5.0V

4-2. LLCR:

VBUS & GND PINS AND OTHER PINS: 40mΩ/PIN MAX.

SHIELD: 50mΩ/MAX.

LLCR MAX. CHANGE OF ALL PINS: 10mΩ

4-3.INSULATION RESISTANCE: 100MΩ MIN

4-4.DIELECTRIC WITHSTAND VOLTAGE,AC 100V FOR 1 MINUTE.

**5. ENVIRONMENTAL PERFORMANCE:**

OPERATING TEMPERATURE: -25°C~+85°C.

**6.IR REFLOW:**

THE PEAK TEMPERATURE ON THE BOARD SHALL

BE MAINTAINED FOR 10 SECONDS AT 260°C.

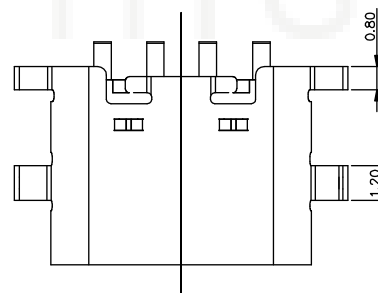
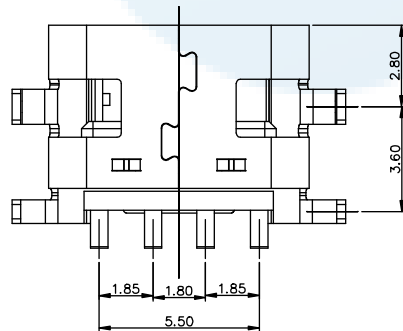
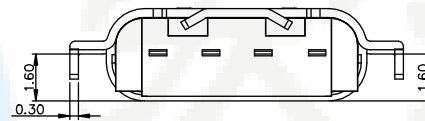
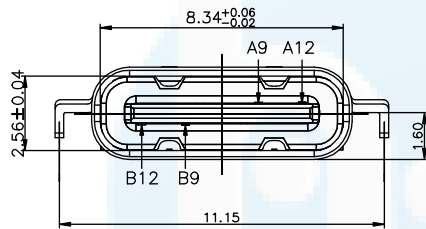

**PIN ASSIGNMENTS**

A9	VBUS	B12	GND		
A12	GND	B9	VBUS	L	L=6.5
PIN	SIGNAL NAME	PIN	SIGNAL NAME	L	L=6.8

DESIGN	Li Jinwei	SCALL		 TOLERANCE X.X ±0.30 X.°±2° .XX ±0.20 .X°±1° .XXX ±0.10 .XX°±0.5°
DRAWING	Wu Qifa	UNIT	mm	
CHECK	Zheng Jinxian	SIZE	A4: 210 * 297	
APPROVAL	Liu Xiaohong	DATE	2020-06-10	

DRAWG NO.

TYPE-C-CDS04P160

TITLE:

4P沉板1.6 四脚插板



**东莞市宏煜盛实业有限公司**  
Dongguan hongyusheng Industry Co., Ltd  
TEL: 0769-81230179 <https://www.hystypec.com>